

ION™

PARTY SPLASH™

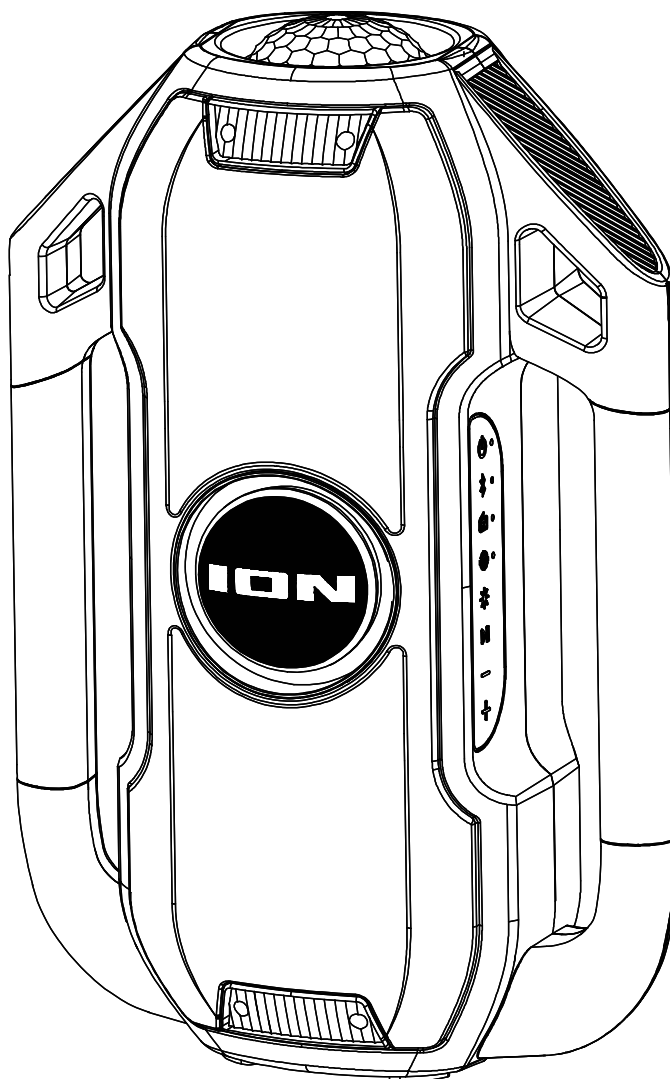

User Guide

English



ionaudio.com/support

TABLE OF CONTENTS

INTRODUCTION	3
Box Contents.....	3
Support.....	3
SETUP	4
Use and Care	4
Charging & Battery Information	5
FEATURES	6
Top Panel	6
Rear Panel.....	8
OPERATION.....	9
App Control.....	9
Pairing a Bluetooth® Device.....	10
Call Answering	11
Stereo-Link™: Linking Two Speakers.....	12
Using the Radio	13
TROUBLESHOOTING	14
APPENDIX.....	15
Technical Specifications.....	15
Trademarks & Licenses	15

INTRODUCTION

Thank you for purchasing the Party Splash™. At ION, your entertainment is as important to us as it is to you. That's why we design our products with one thing in mind—to make your life more fun and more convenient.

Note: Before you first use the product, please fully charge the batteries. Your unit was purposely shipped with a reduced battery charge to ensure safe transit. For optimal charging, power off the speaker while charging.

Use the included micro-USB cable to connect the unit to a 5V, 2A power adapter (not included) connected to a power outlet and let it charge for up to 4 hours (depending on the specifications of your adapter). This helps ensure the longest life for your battery.

Box Contents

Party Splash™

Micro-USB Charging Cable (3.28 ft / 1 m)

Quickstart Guide

Support

For the latest information about this product (documentation, technical specifications, system requirements, compatibility information, etc.) and product registration, visit ionaudio.com.

For additional product support, visit ionaudio.com/support.

SETUP

Use and Care

Please review the tips below to get the best performance from your Party Splash™ speaker:

- Party Splash™ is IP67 waterproof, submersible up to 3 ft. (1 m) for 30 minutes, and dust-/dirt-/sand-proof.
- If the speaker fills with water, the sound will be muffled until the water has drained.
- If Party Splash™ is exposed to saltwater, we recommend that you rinse it with tap water to maintain long-term performance of the product.
- Place Party Splash™ in the upright position for the best sound experience. Party Splash™ will float in the position that it was placed or tossed into the water (for example, if placed on its side, Party Splash™ will continue to float on its side).
- Please do not attempt to charge Party Splash™ in a wet environment. Make sure the power input, micro-USB cable, power adapter, and power outlet are all completely dry before making any connections.
- **WARNING:** Keep any non-water-resistant devices (phones, music players, etc.) in a dry place where they will not be affected by water and cause a risk of electric shock.

Charging & Battery Information

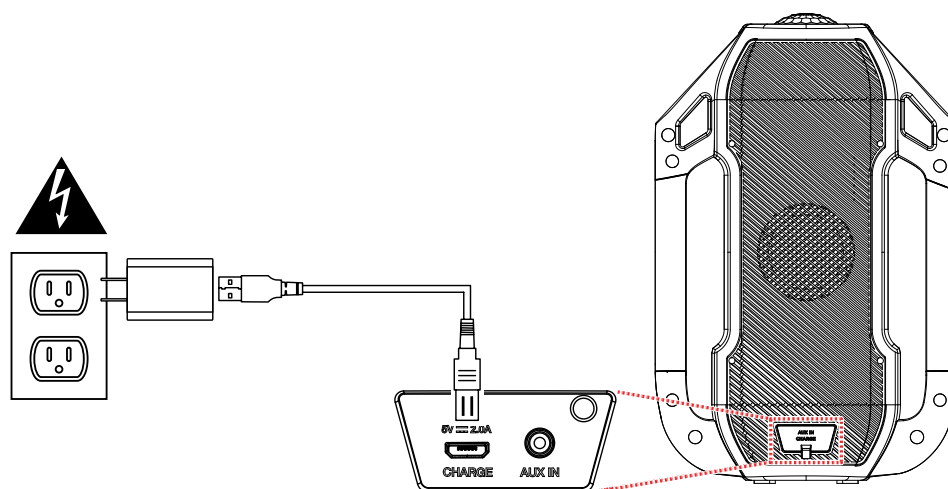

For the quickest charging time, power off Party Splash™ and use the included micro-USB cable to connect the micro-USB charging port on the rear panel of the speaker to a USB power adapter (DC 5V, 2A; not included) connected to a power outlet, or your computer (powered on). A full charge can take up to 4 hours, depending on the specifications of your 5V, 2A adapter.

If there is no audio coming from a Bluetooth device or the aux input for 15 minutes, Party Splash™ will automatically power off to save battery. To wake the unit, simply resume audio playback.

Here are some other recommendations for getting the longest life from the internal battery.

General Usage Fully charge the battery before using it.

Avoid full discharge of the battery if possible. Li-Ion batteries are maintenance-free, and the battery will last longest when operating between 30–80% charged.

Do not use the product while charging the battery.

Do not charge the battery in exceedingly hot (greater than 90°F/32°C) or exceedingly cold (less than 32°F/0°C) temperatures.

Storage For best product longevity, do not store at exceedingly hot (greater than 90°F/32°C) or exceedingly cold (less than 32°F/0°C) temperatures.

For best product longevity, store with a 50% battery charge.

If you leave the battery level low and do not charge it for 6 months, it may permanently lose capacity.

Repair If the battery fails to charge, contact ION Audio at ionaudio.com.

Disposal Bring the unit to a recycling center or dispose of in accordance with local ordinances.

FEATURES

Top Panel

Click a control below to jump to that section.

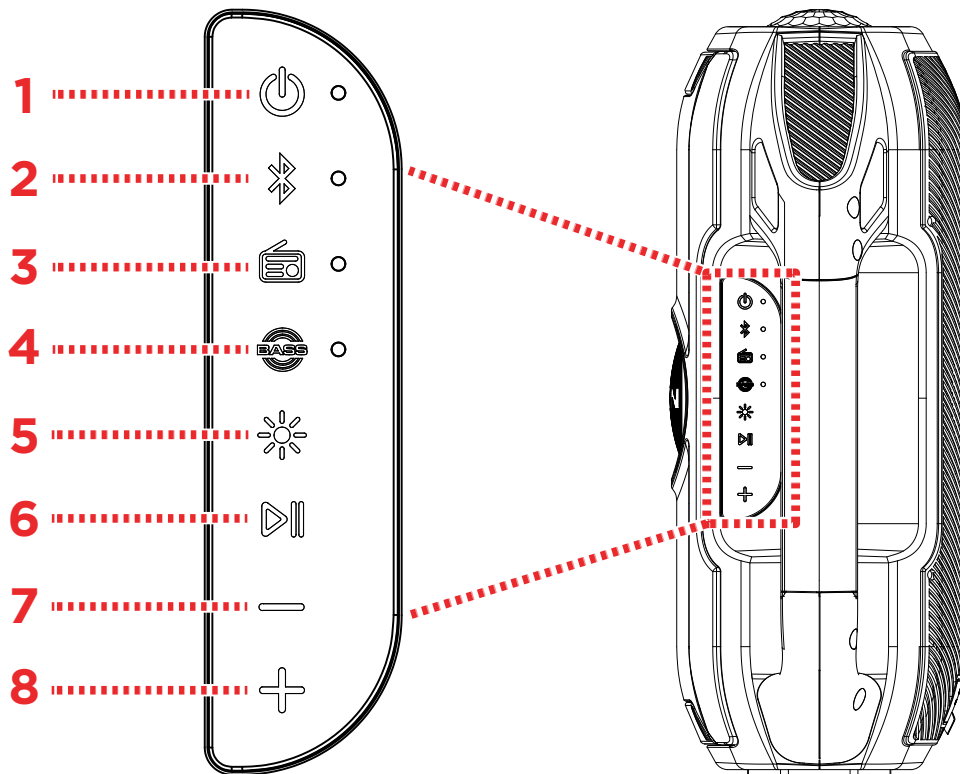

1. Power Button

Press and hold this button to power Party Splash™ on and off. The LED next to this button will change based on the current status of Party Splash™:

- **Solid White:** Power on.
- **Flashing Red:** Low battery.
- **Solid Red:** Charging. If the unit is powered off, the LED will turn off once charging is complete. Battery status can also be seen from the **ION Sound Control™** app.

Double-press this button to activate or deactivate the voice prompts.

2. Bluetooth Button

Press this button to enter Bluetooth pairing mode. See [Operation > Pairing a Bluetooth® Device](#) to learn more.

3. Radio Button

Press this button to enter or exit FM radio mode. See [Operation > Using the Radio](#) to learn more.

4. Bass Boost Button

Press this button to activate or deactivate Bass Boost, which enhances the bass EQ while in Bluetooth mode.

5. Light Mode Button

Press this button to cycle through the five available light modes, or to turn the lights off:

- **Beat Sync:** The lights change color and flash in reaction to the beat of the music.
- **Color Cycle:** The lights slowly glow and fade through colors.
- **Beathing Color:** All lights glow in the same color, fading in and out while cycling through the full color spectrum.
- **Solid Color:** The lights will all be lit in a single color (by default, blue). You can change the color using the **ION Sound Control™** app.
- **Random:** The lights cycle through the other four color modes randomly, changing every 5-7 seconds.
- **Off**

6. Play/Pause

Press this button to play or pause playback from a connected Bluetooth device.

7. Volume Down / Previous

Press this button to increase playback volume.

In Bluetooth mode, press and hold this button to revert to the previous track, and press again within one second to skip to the previous track.

In Radio mode, press and hold this button to seek the previous strongest station.

8. Volume Up / Next

Press this button to increase playback volume.

In Bluetooth mode, press and hold this button to skip to the next track.

In Radio mode, press and hold this button to seek the next strongest station.

Rear Panel

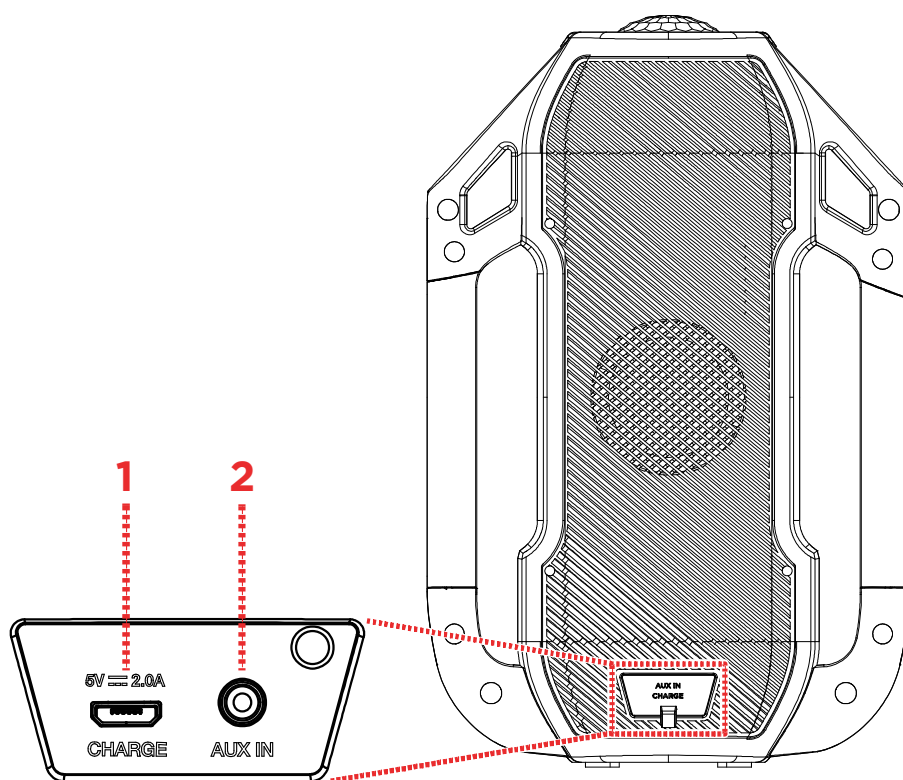

1. Micro-USB Port

To charge Party Splash™, connect the included micro-USB cable from this port to a USB power adapter (DC 5V, 2A; not included) connected to a power outlet.

2. Aux Input

This 1/8" (3.5 mm) input can be used to connect a CD player, MP3 player, or other auxiliary audio source.

Note:

- While in Bluetooth mode or FM mode, connecting a cable to the Aux input will automatically switch Party Splash™ to Aux mode.
- If the cable is removed while in Aux mode, Party Splash™ will revert to the last mode it was last in, either FM or Bluetooth.

App Control

IMPORTANT: To ensure the best possible experience with the app, use the most current Android OS or iOS on your device.

Follow these steps to download the free app on your device:

1. Open the Apple App Store or Google Play on your device. Then, search for the **ION Sound Control™** app.
2. Follow the on-screen instructions to download and install the app. Once downloaded, the **ION Sound Control™** app will appear on your device's home screen.
3. Connect your device to Party Splash™ via Bluetooth. See [Operation > Pairing a Bluetooth® Device](#) to learn how to do this.
4. Open the ION Sound Control™ app. If prompted, allow the app to access your device's Bluetooth and Location Services.
5. Follow the steps on screen to find and connect to your Party Splash™. Once connected, you can control various functions of the speaker, such as:
 - **Volume:** Adjust the speaker's volume.
 - **Voice Prompts:** Enable or disable the voice prompts (on by default).
 - **Battery Life:** Check the speaker's battery life status.
 - **Radio:** Play the radio, change stations, and edit presets.
 - **EQ:** Adjust the speaker's equalization.
 - **Lights:** Change the light modes and select colors.
 - **Support:** Visit ionaudio.com, contact Technical Support, and view Warranty information and Frequently Asked Questions.

Pairing a Bluetooth® Device

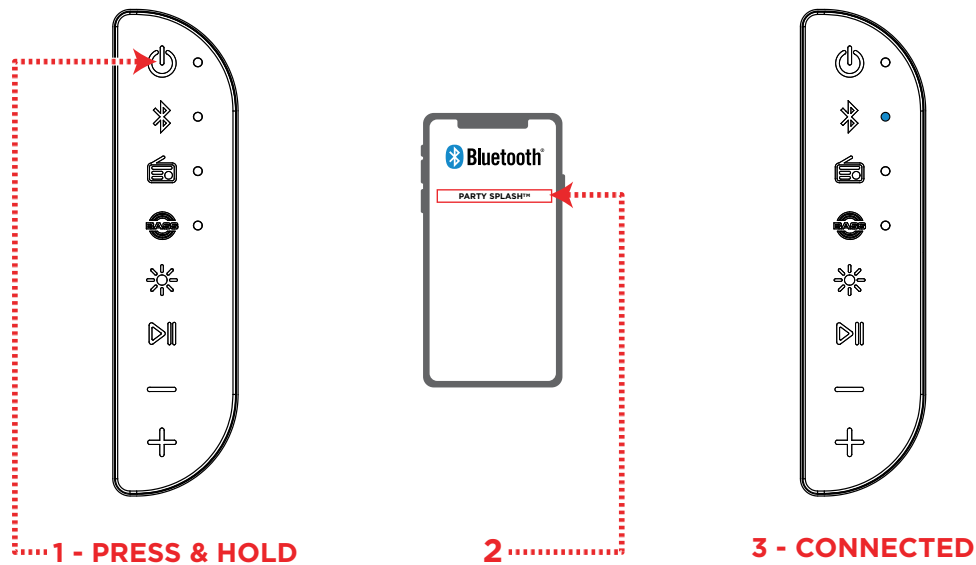

1. Turn on Party Splash™ by pressing and holding the **Power** button. Upon powering on, Party Splash™ will be available to pair, so make sure your Bluetooth device is within range of the speaker, no more than 100 ft. (30.5 m).

If Party Splash™ is powered on and you are in FM mode or using the Aux input, you will need to press the **Bluetooth** button to switch to Bluetooth mode.

2. Navigate to your device's Bluetooth setup screen, find **PARTY SPLASH**, and connect.

Note: Do not connect to **iSP149B_BLE**; this is reserved exclusively for connecting to the ION Sound Control™ app. If you experience trouble in connecting, select “Forget this Device” on your Bluetooth device and try to connect again.

3. Once paired, you will hear “Connected” (if voice prompts are enabled), and the LED next to the **Bluetooth** button will become solid blue.
4. You can now press play in your music player app of choice on your device.

To disconnect a paired device, press and hold the **Bluetooth** button, or turn off Bluetooth from your device's Bluetooth settings. The speaker will enter Bluetooth pairing mode to make it available for another device. When you disconnect a Bluetooth device, you will hear “Disconnected” if voice prompts are enabled.

Call Answering

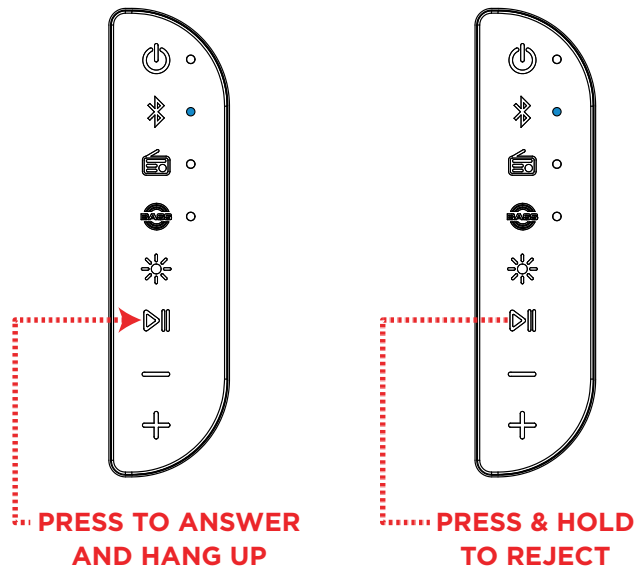

To answer an incoming call when connected via Bluetooth, quickly press and release the Play/Pause button. Bluetooth playback will be paused until the call is completed or rejected.

To reject an incoming call, press and hold the Play/Pause button.

To control the volume of the caller, press the +/- buttons.

To end a call and unpause Bluetooth playback, press the Play/Pause button.

Stereo-Link™: Linking Two Speakers

Note: In order to use Stereo-Link™ mode, you cannot have a Bluetooth device connected. If another Party Splash™ is connected to a Bluetooth device, disconnect by pressing and holding the **Bluetooth** button.

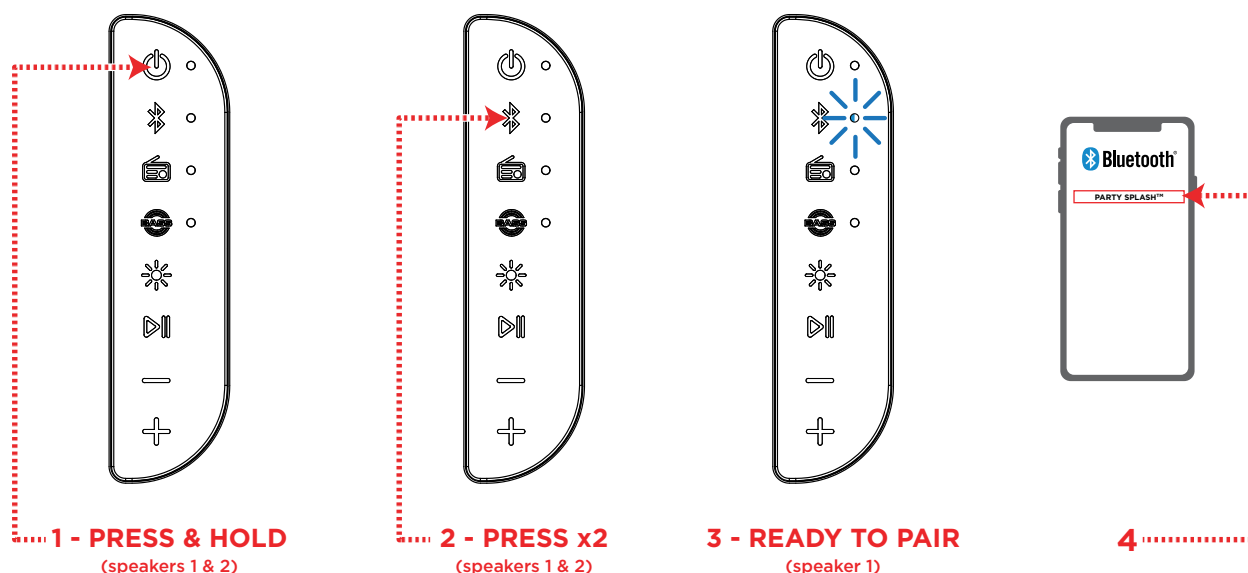

To link two speakers together:

1. Press and hold the **Power** buttons on both Party Splash™ speakers.
2. Double-press the Bluetooth button on one speaker. Repeat this for the second speaker. The speakers will search for each other to link as the blue LEDs next to the **Bluetooth** buttons begin to blink fast.

Note: It may take up to 1 minute to make the connection.

3. When the two speakers are “linked,” one speaker’s blue LED will be lit solid, while the other speaker’s blue LED will blink slowly to indicate it’s ready to pair the stereo-linked speakers to your Bluetooth device.
4. Navigate to your Bluetooth device’s setup screen, find **PARTY SPLASH**, and connect.

To disconnect, double press the **Bluetooth** button on one of the two speakers.

Note: If a speaker is in Stereo-Link™ mode when you power it off, it will be in Stereo-Link™ mode the next time you power it on (they will automatically link when you power them on as long as they are in close range of each other and powered on within 15 seconds of each other).

Using the Radio

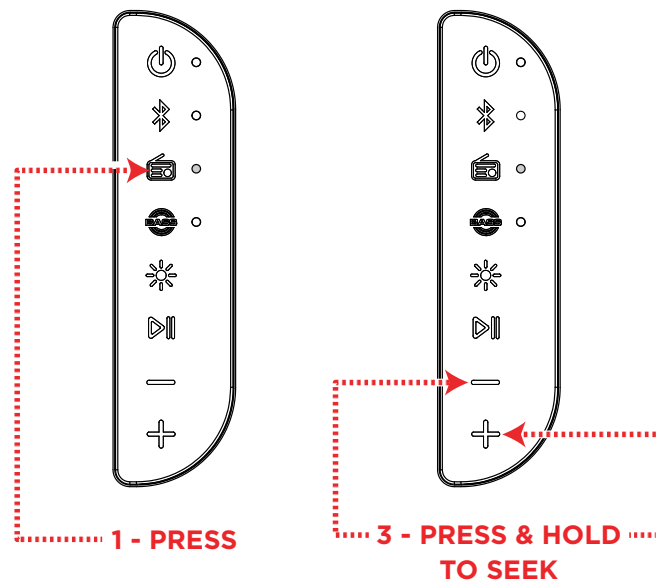

1. Press the **Radio** button. The LED next to this button will light up when FM radio mode is activated.
2. Press and hold the +/- buttons to seek to the next or previous strongest station.

To save a radio station as a preset, use the ION Sound Control™ app. See [Operation > App Control](#) for more information.

To recall a saved preset station, press the **Play/Pause** button.

TROUBLESHOOTING

If the unit is not charging: Make sure the micro-USB charging cable is properly connected to the power input, the power adapter, and the power outlet.

If the sound is distorted: Try lowering the volume control of your sound source.

If there is too much bass: Try adjusting the tone or EQ control on your sound source or on Party Splash™ via the ION Sound Control™ App to lower the bass level. This will allow you to play the music louder before clipping (distortion) occurs.

If you cannot connect your audio device to Party Splash™ via Bluetooth:

- Have your audio device (e.g., smartphone or tablet) and Party Splash™ as close together as possible while trying to connect. Make sure both the audio device and Party Splash™ are unobstructed by walls, furniture, etc.
- Double-press the Bluetooth button to disconnect Party Splash™ from any other audio device and restart the search process. If this does not work right away, power off Party Splash™ and then power it back on. See [Operation > Pairing a Bluetooth® Device](#) for more information.
- Reset the Bluetooth connection on your audio device by turning Bluetooth off and back on. You can find this under the Bluetooth menu in the Settings for your phone or other audio device.

If this does not work, and you have connected to Party Splash™ before, find Party Splash™ in the list of available or previously connected devices in your audio device's Bluetooth menu, tap the "gear" or "i" icon located next to it and then select **Unpair** or **Forget**. Turn Party Splash™ off and back on and try pairing again once it reappears in your available devices list.

Note: If Party Splash™ have been paired to another audio device recently that is still within range, you may need to repeat this process with that audio device to fully disconnect.

If you experience audio dropouts while playing music from a Bluetooth device, this may be happening because your unit is trying to link to another speaker. This can occur if you power off a speaker that was linked to your unit or if you have just turned on your unit and it is in Stereo-Link™ mode. To stop the audio dropouts, exit Stereo-Link™ mode by double-pressing the **Bluetooth** button. Alternatively, you can wait for your unit to link to another speaker if there is one within range.

If there is a delay in the audio signal between the left and right speakers when linked, break the link by double-pressing the **Bluetooth** button, and pair them again following the instructions in the [Operation > Stereo-Link™: Linking Two Speakers](#) section.

APPENDIX

Technical Specifications

Output Power	30 W (peak)
Frequency Response	125 Hz – 15 kHz
Drivers	2" (63.5 mm) x2
Water Resistance Class	IP67
Bluetooth Specifications	Profile: A2DP, AVRCP Bluetooth Version: 5.0 Range: Up to 100 ft. (30.5 m) * Stereo-Link™ Range: Up to 100 ft. (30.5 m) between speakers
Battery	Battery life: Up to 10 hours ** Charge Time: Up to 5 Hours
Dimensions (width x depth x height)	7.76" x 4.69" x 11.65" 197 x 119 x 296 mm
Weight	3.57 lbs. 1.62 kg

Specifications are subject to change without notice.

* Bluetooth and wireless reception and range are affected by walls, obstructions, and movement. For optimal performance, place the product so it is unobstructed by walls or furniture and is raised off the ground.

** Battery life may vary based on temperature, age, and volume usage of product.

Trademarks & Licenses

ION Audio is a trademark of inMusic Brands, Inc., registered in the U.S. and other countries.

The *Bluetooth* word mark and logos are owned by the Bluetooth SIG, Inc., and any use of such marks by ION Audio is under license.

App Store is a trademark of Apple Inc., registered in the U.S. and other countries.

Android and Google Play are registered trademarks of Google Inc. All other product names, company names, trademarks, or trade names are those of their respective owners.



ionaudio.com